

SWITCH PANELS OPTION HANDSET

RS-140, RS-143, RS-144 RS-141

1. GENERAL DESCRIPTION

The RS-140, RS-143, and RS-144 are substations to be connected to the 2-Core Shielded Substation Interface Unit. The RS-141, designed exclusively for indoor-use in combination with the RS-140, RS-143, or RS-144, is an option handset to make handset conversations.

For operation of the units, refer to the N-8000 series instruction manual.

Warning

This is a class A product. In a domestic environment this product may cause radio interference in which case the user may be required to take adequate measures.

2. APPEARANCE

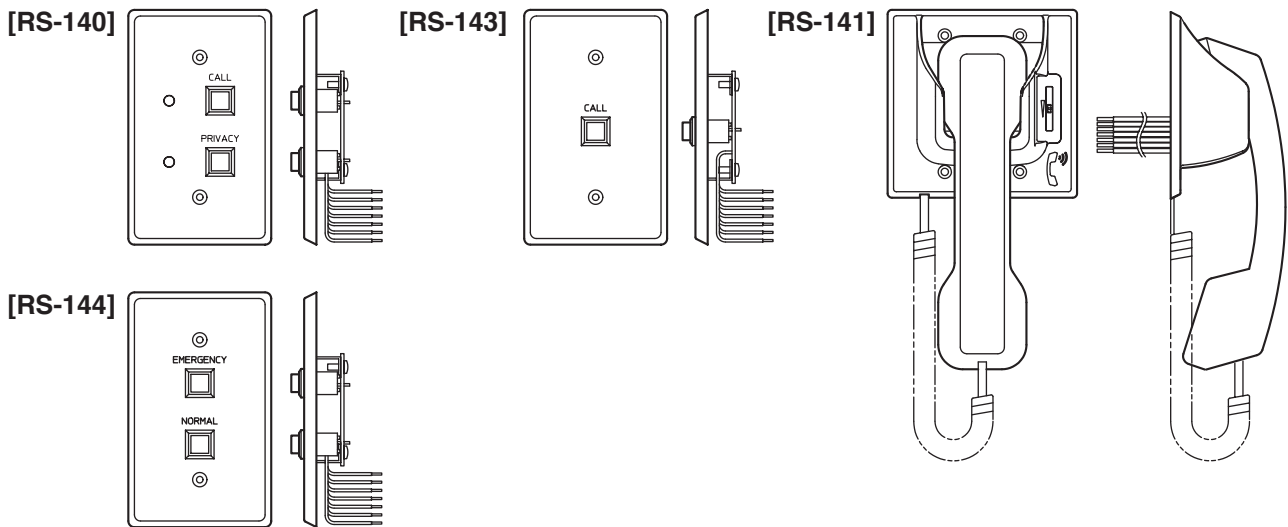

3. CONNECTIONS

3.1. Switch Panel Connections (When the Option Handset is not used)

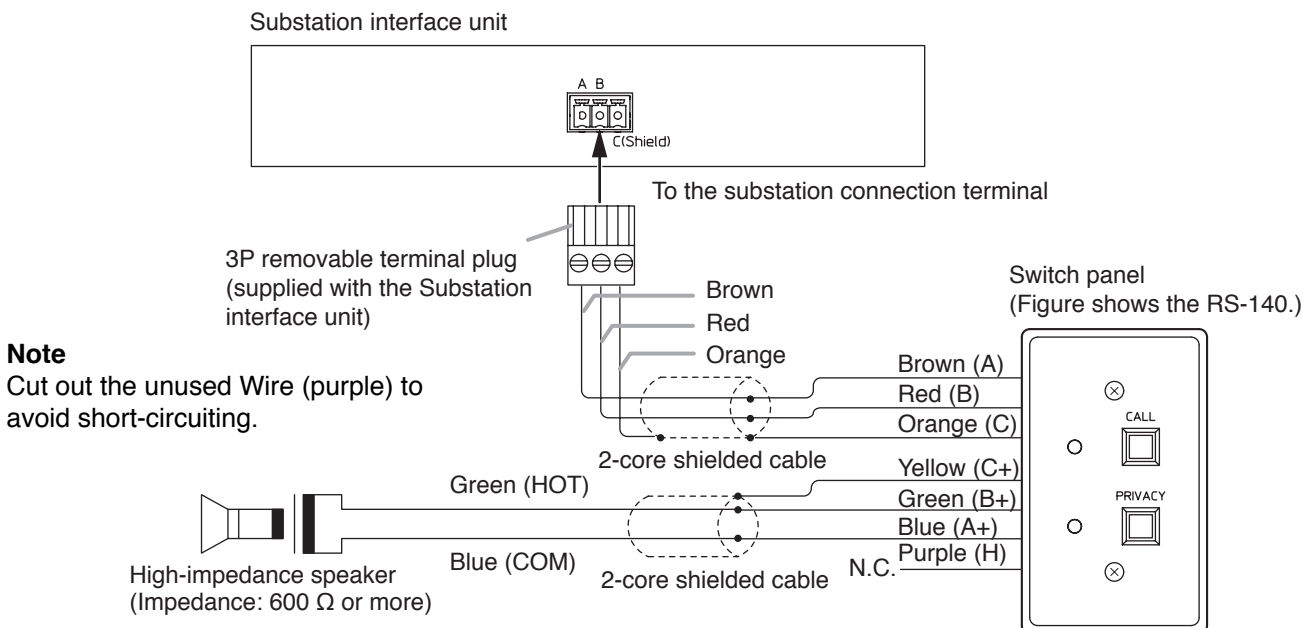

Note

Cut out the unused Wire (purple) to avoid short-circuiting.

3.2. Switch Panel and Option Handset Connections

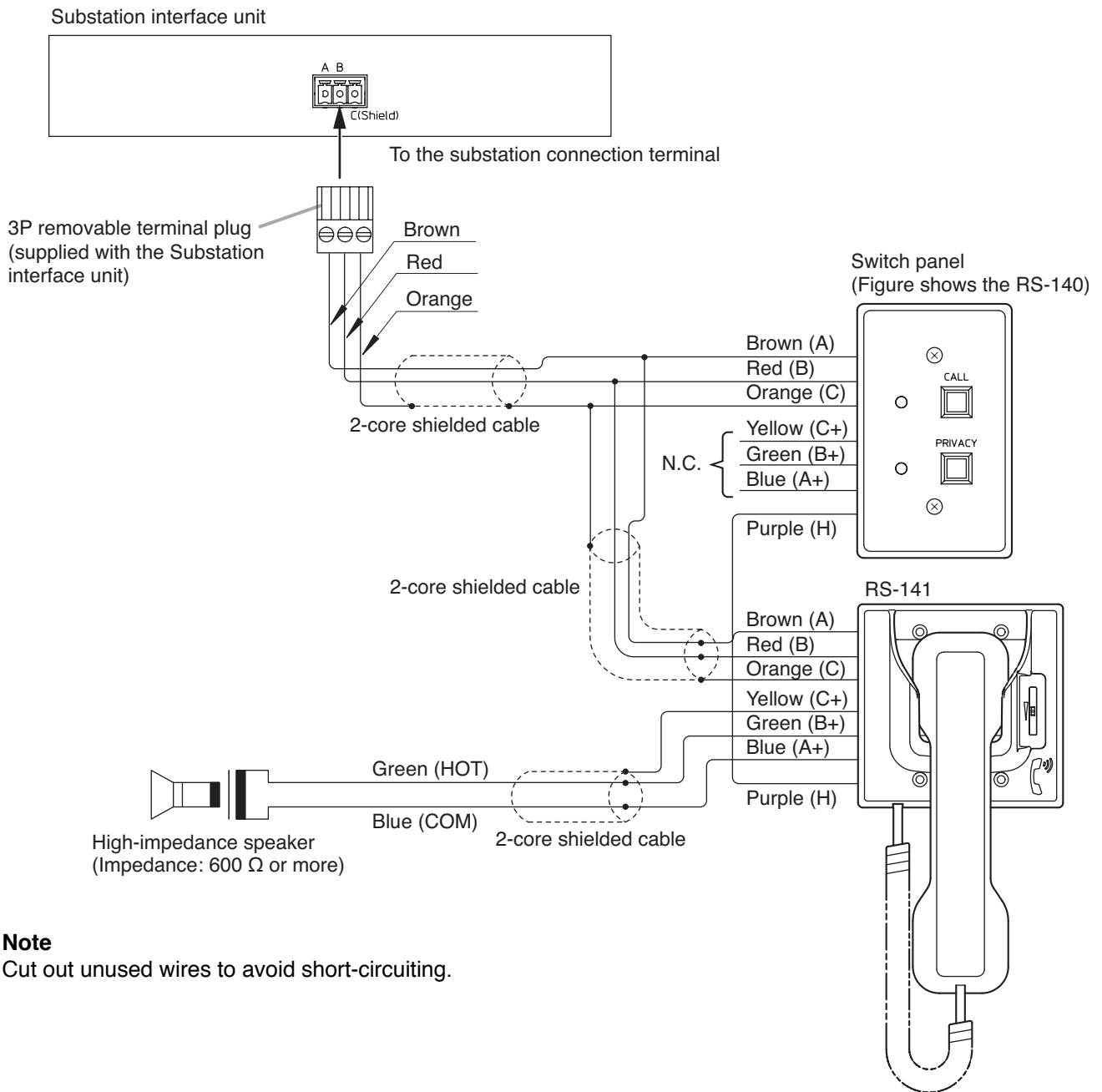

4. INSTALLATION

4.1. Switch Panel Installation

4.1.1. Dimensional diagram

[RS-140]

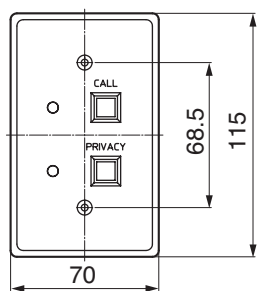

[Mounting bracket (Supplied with the RS-140/143/144)]

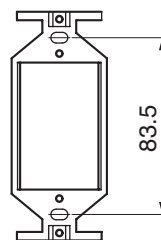

Unit: mm

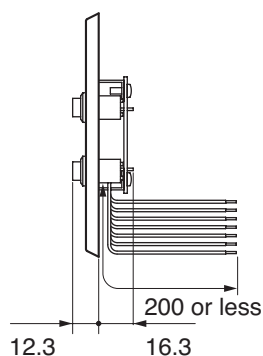

Note: The dimensions of RS-143 and RS-144 are the same as above.

Note

When using the PA paging function, keep the switch panel as far away from the PA paging speaker as possible to avoid acoustic feedback.

4.1.2. In-wall mounting using an electrical box

Mount the RS-140/143/144 to the YC-801 Flush-mount box mounted in the wall.

Accessory screws

The RS-140/143/144 comes with 2 types of screws to match the box screw threads: M4 x 30 and UNC No. 6-32 x 30. For the electrical box provided with unified threads, use the UNC No. 6-32 x 30.

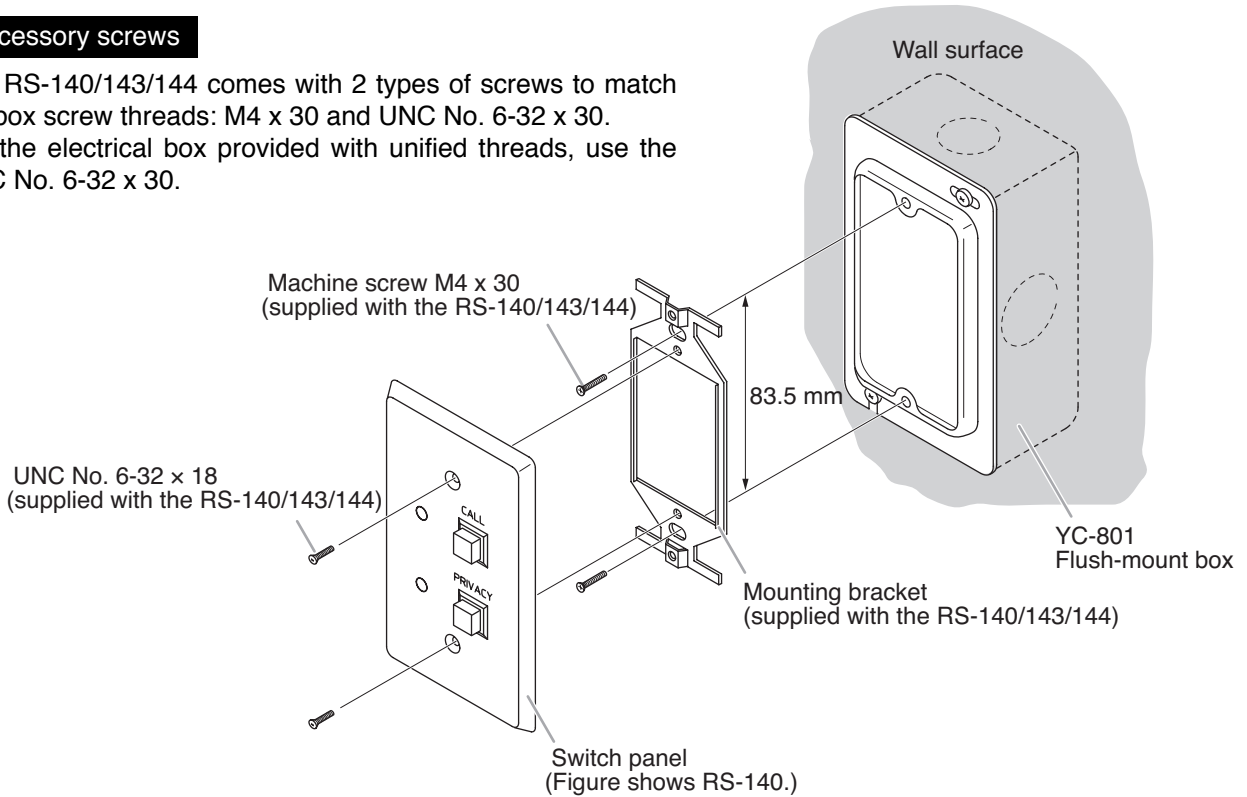

4.1.3. On-wall mounting using a wall-mount box

Attach the RS-140/143/144 to the YC-802 Wall-mount box installed on a wall.

Accessory screws

The RS-140/143/144 comes with 2 types of screws to match the box screw threads: M4 x 30 and UNC No. 6-32 x 30. For the electrical box provided with unified threads, use the UNC No. 6-32 x 30.

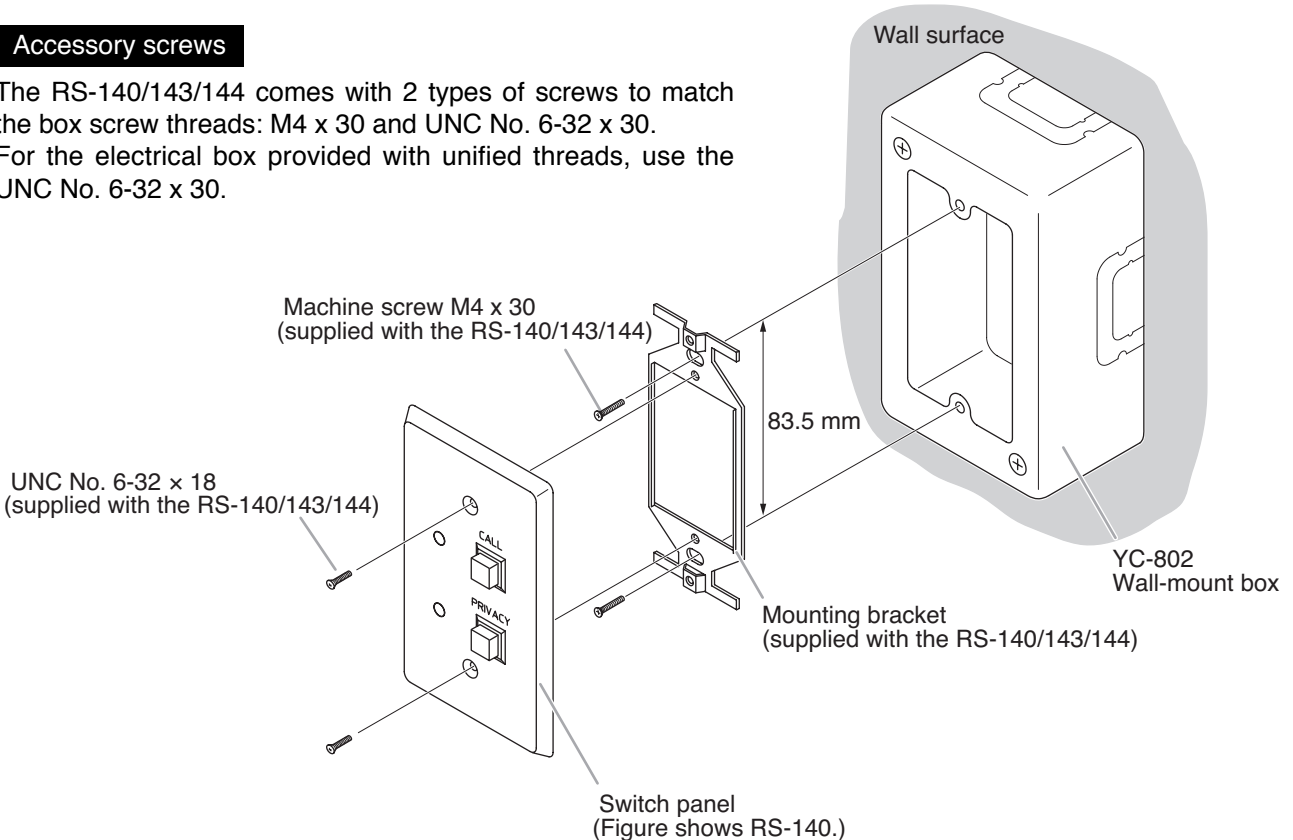

4.2. Option Handset Installation

Mount the option handset to an electrical box mounted in the wall.

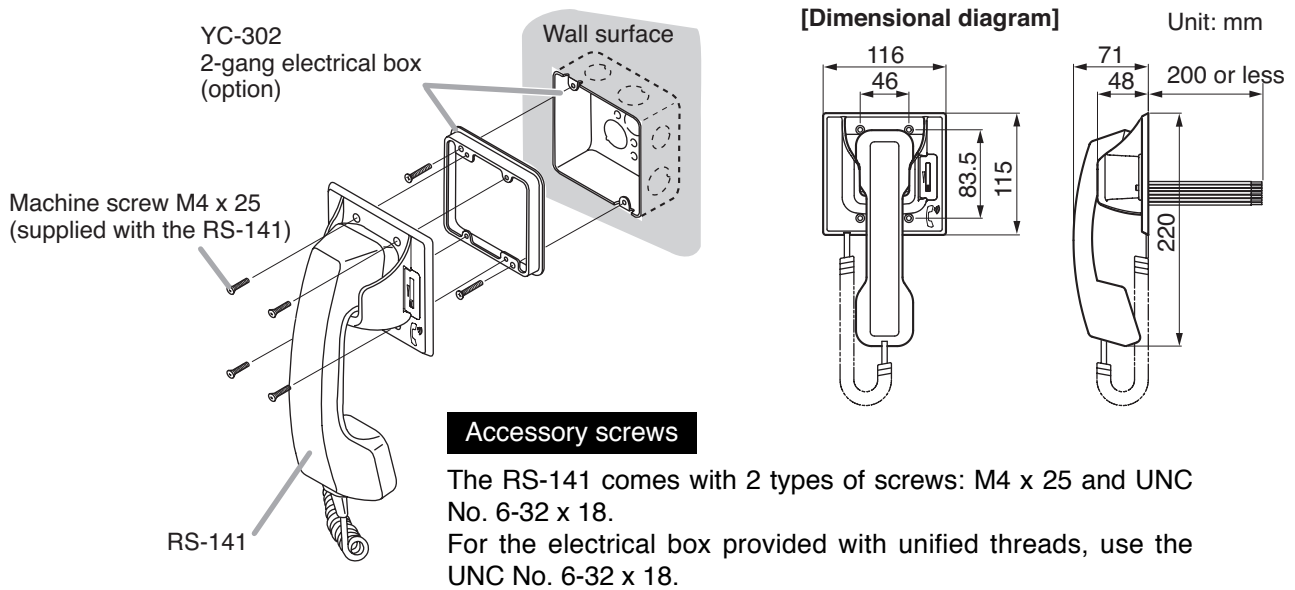

5. SPECIFICATIONS

Model Number	RS-140	RS-143	RS-144
Call Button 1	Momentary (CALL)		Momentary (EMERGENCY)
Call Button 2	—		Momentary (NORMAL)
Privacy Button	Latching (PRIVACY)	—	
Call Indicator	Flashing red	—	
Conversation Indicator	Lit red	—	
Privacy Indicator	Lit red	—	
Wiring	2-core shielded cable		
Transmission Distance	500 m/ø0.5 mm (AWG24), 800 m/ø0.65 mm (AWG22), 1300 m/ø0.9 mm (AWG19)		
Operating Temperature	0 to +40°C		
Finish	Panel	Stainless steel, hairline	
	Call Button 1	Resin, red	
	Call Button 2	—	Resin, white
	Privacy Button	Resin, white	—
Dimensions	70 (w) x 115 (h) x 28.6 (d) mm		
Weight	80 g		
Accessory	Mounting bracket ... 1, No. 6-32 UNC x 18 ... 2, Machine screw M4 x 30 ... 2, No. 6-32 UNC x 30 ... 2		
Applicable Box	Flush-mount box: YC-801 (option) Wall-mount box: YC-802 (option)		

Model Number	RS-141
Handset Receiver	Dynamic type
Handset Microphone	Electret condenser type
Wiring	2-core shielded cable
Handset Receiver Volume Control	Slide volume Maximum attenuation level: 12 – 18 dB
Operating Temperature	0 to +40°C
Finish	ABS resin, pale white
Dimensions	116 (w) x 220 (h) x 71 (d) mm
Weight	350 g
Accessory	No. 6-32 UNC x 18 ... 4, Machine screw M4 x 25 ... 4
Applicable Box	2-gang electrical box: YC-302 (option)

Traceability Information for Europe (EMC directive 2004/108/EC)

Manufacturer:
TOA Corporation
7-2-1, Minatojima Nakamachi, Chuo-ku, Kobe, Hyogo, Japan

Authorized representative:
TOA Electronics Europe GmbH
Suederstrasse 282, 20537 Hamburg, Germany